

 CZECH SPORT AIRCRAFT	<h1>SERVICE BULLETIN</h1>	Czech Sport Aircraft a.s. Na Záhonech 212, 686 04 Kunovice Czech Republic office@czechsportaircraft.com	
		No.: SB-CR-049	Rev.: -
		Date: 2018-04-09	Date: -
Page: 1 of 4			

MODEL AFFECTED:	PS-28 Cruiser
SUBJECT:	Replacement of the landing light circuit breaker MS3320
AIRCRAFT AFFECTED:	S/N C0601, S/N C0602, S/N C0605, S/N C0607
COMPLIANCE:	Apply this Service Bulletin immediately after receiving the circuit breaker MS3320-3 replacement package

DESCRIPTION:

This Service Bulletin contains instructions for replacement of the MS3320-4 (current value of 4A) by the MS3320-3 (current value of 3A) circuit breaker for the Kuntzleman 11-06854 landing light (LDG L).

REASON:

The aircraft shown in the Section "AIRCRAFT AFFECTED" were fitted with the LDG L circuit breaker MS3320-4 installed, with the incorrect current value of 4A, while the MS3320-3 (current value 3A) is the correct one. Therefore, replacement of the LDG L circuit breaker by the MS3320-3 is needed.

If this Service Bulletin is not performed and replacement instructions not followed, the original MS3320-4 LDG L circuit breaker with the incorrect current value of 4A could cause a damage to the landing light.

AUTHORISATION TO PERFORM:

EASA Part M or Part 145 Maintenance organization.

MANPOWER:

Approximately 1 hour.

SPECIAL TOOLS:

Common maintenance and electrical / avionics tools for aircraft servicing. Wrench ½ inch.

WEIGHT AND BALANCE:

Not affected.

ELECTRICAL LOAD DATA:

Not affected.

REFERENCES:

N/A

PUBLICATIONS AFFECTED:

POH-1-1-12, Supplement No.2

MATERIAL:

Package with the MS3320-3 circuit breaker and updated Supplement No.2 of the POH-1-1-12 can be ordered from the aircraft manufacturer.

COSTS:

To be covered by the aircraft owner/operator. The package with the MS3320-3 circuit breaker will be provided free of charge by the aircraft manufacturer.



SERVICE BULLETIN

ACCOMPLISHMENT INSTRUCTIONS:

The MS3320 LDG L circuit breaker is installed on the right instrument panel, see Fig 1, and is marked by the text "LDG L".

Replacement of the circuit breaker has no effect on mass and CG of the airplane.

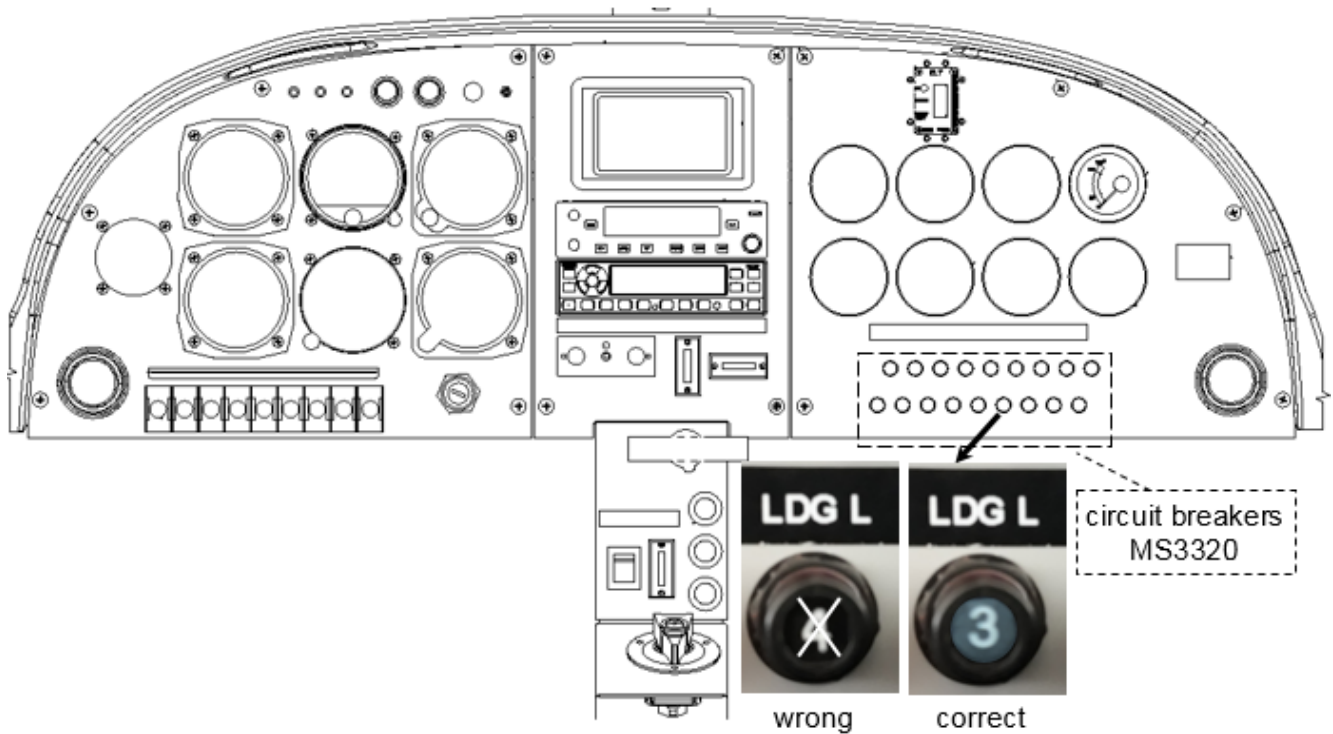

Fig.1: The LDG L MS3320 circuit breaker on the right instrument panel

Note: The instrument panel on Fig.1 is illustrative only, and may differ depending on the aircraft equipment.



SERVICE BULLETIN

To accomplish this Service Bulletin carry out the following steps:

1. Exchange of the circuit breaker

- 1.1. Determine the LDG L circuit breaker (text "LDG L") on the right instrument panel, see Fig.1.
- 1.2. Secure that the MASTER BATT switch is turned off and disconnect the battery terminals, see the CR-MM-1-0-00, point 11.3.2, latest revision.
- 1.3. Remove the screws (2) with the washers (3) from the main supply bus (4) of all the circuit breakers, see Fig.2.
- 1.4. Remove the main supply bus (4) from the circuit breakers (1) on the right instrument panel, see Fig.2.

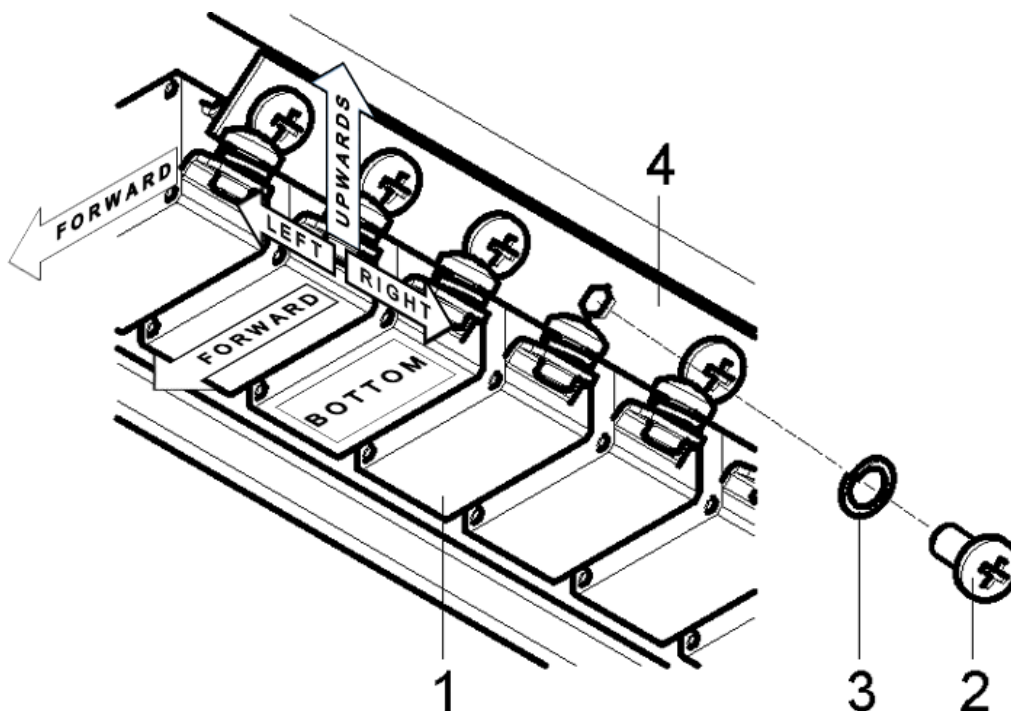

- | | | | |
|---|-----------------|---|-----------------|
| 1 | Circuit breaker | 3 | Lock washer |
| 2 | Screw | 4 | Main supply bus |

Fig.2: Connection of the MS3320 circuit-breakers to the main supply bus

- 1.5. Release the screw (4) with the washer (5), see Fig.3, and disconnect the cable (6) from the LDG L circuit breaker;
- 1.6. Unscrew the nut (2), the washer (3) and remove the LDG L circuit breaker (1), see Fig.3. To unscrew the nut (2) use the ½ inch wrench.

Note: The MS3320-3 circuit breaker hardware - screw (4), nut (2), washers (3; 5), see Fig.3, are included in the replacement package that shall be provided by the aircraft manufacturer.



SERVICE BULLETIN

No.: SB-CR-049

Date: 2018-04-09

Page: 4 of 4

Rev.: -

Date: -

- 1.7. Use the new LDG L circuit breaker from the replacement package (MS3320-3, the current value of 3A), see Fig.1, insert it back in the right instrument panel and fix using the nut (2) with the washer (3), see Fig.3.
- 1.8. Connect the cable (6) using the screw (4) with the washer (5), see Fig.3.
- 1.9. Fix the main supply bus (4) back to the all circuit breakers using the screws (2) with the washers (3), see Fig.2.

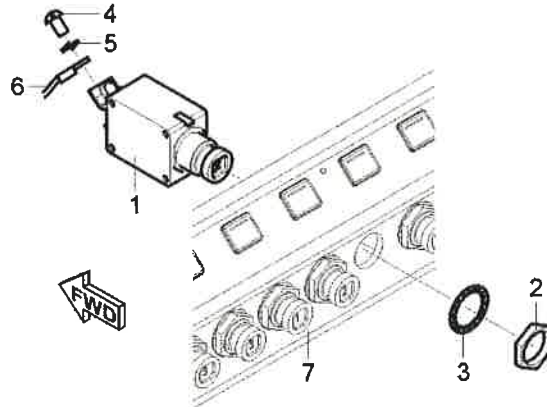

- | | |
|-------------------------|--------------------------|
| 1 LDG L Circuit-breaker | 5 Lock washer |
| 2 Nut | 6 Cable |
| 3 Lock washer | 7 Right instrument panel |
| 4 Screw | |

Fig.3: MS3320 circuit breaker removal / installation

- 1.10. Connect the battery terminals (see the CR-MM-1-0-00, point 11.3.3, latest revision), turn the MASTER BATT switch ON, switch the LDG L switch circuit breaker on the LEFT instrument panel ON and verify function of the new LDG L circuit breaker on the RIGHT instrument panel (switch it ON / OF).
- 1.11. Restore the airplane to the airworthy condition.
- 1.12. Replace the Page No.7-8 of the POH-1-1-12 Supplement No.2 (delivered with the replacement package).
- 1.13. Update the airplane maintenance records to reflect compliance with this Service Bulletin.

APPROVAL:

This Service Bulletin has been approved by:

Title	Head of the Design Organisation	Airworthiness Manager
Name	Jiří Konečný	Miroslav Koukal
Signature		